

38 Woodgreen Road, Luton, LU2 8BU  
£1,950 PCM



- Four spacious bedrooms
- Downstairs WC
- Close to Luton Airport and transport links
- Large open-plan kitchen diner
- Private garage
- Available now
- Off-street parking on driveway
- Luxury contemporary interior
- Must be viewed

**\*\* Exclusive to PR Property \*\*** This impressive four-bedroom semi-detached house on Wood Green Road, Stopsley, Luton, features a large open-plan kitchen diner, perfect for modern family living and entertaining. The luxury finish throughout enhances the spacious interior, seamlessly connecting cooking, dining, and living areas. Alongside the sizeable rear garden and off-road parking on the driveway, the home also includes a garage and a practical downstairs WC. Positioned close to Luton Airport and excellent transport links, this property offers both comfort and convenience for busy lifestyles.

**ENTRANCE HALL**

**LIVING ROOM 12'4" X 11'3" (3.78 X 3.43)**

**KITCHEN DINER 18'9" X 11'11" (5.73 X 3.64)**

**WC**

**LANDING**

**BEDROOM ONE 12'0" X 11'5" (3.67 X 3.49)**

**BEDROOM TWO 12'0" X 11'5" (3.67 X 3.49)**

**BEDROOM THREE 7'1" X 6'6" (2.17 X 2.00)**

**BEDROOM FOUR 13'1" X 13'0" (4.01 X 3.98)**

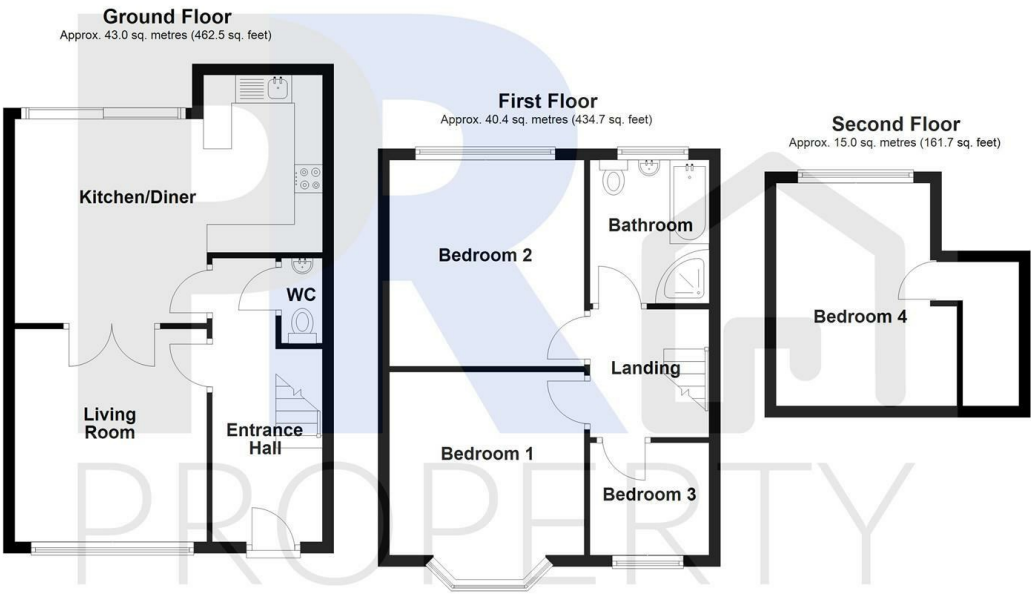

Total area: approx. 98.4 sq. metres (1058.8 sq. feet)  
**38 Woodgreen Road, Luton**

Energy Efficiency Rating		
	Current	Potential
Very energy efficient - lower running costs		
(92 plus) <b>A</b>		
(81-91) <b>B</b>		
(69-80) <b>C</b>		
(55-68) <b>D</b>		
(39-54) <b>E</b>		
(21-38) <b>F</b>		
(1-20) <b>G</b>		
Not energy efficient - higher running costs		
England & Wales		EU Directive 2002/91/EC