



---

# first floor office space, Fog Lane, East Didsbury, Manchester

£400 pcm

Self-Contained First Floor Office – East Didsbury

---

## Description

This upper-floor premises, accessed via its own private rear entrance,

Large main office room (approx. 4.5m x 6m)

Additional office/storage room 3.5 x 2.5M

Kitchen area

Bathroom facilities



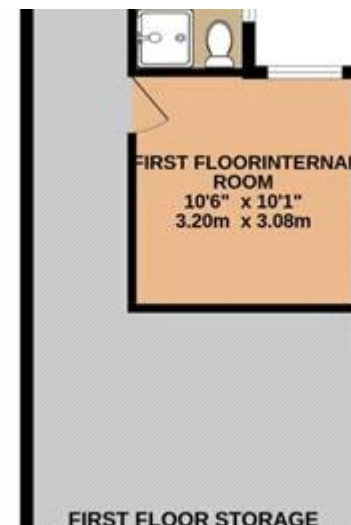

Viewing by appointment only  
Property Market Hub - Sales & Lettings  
151 Fog Lane, Manchester M20 6FJ  
Tel: 0161 6355 888 Email: [info@propertymarkethub.co.uk](mailto:info@propertymarkethub.co.uk) Website:  
<https://www.propertymarkethub.co.uk>

