

LET AGREED



House - Semi-Detached (EPC Rating: C)

82 HEMPCROFT ROAD, TIMPERLEY, WA15 7JF

Per month

£1,550 Per month



3 Bedroom House - Semi-Detached located in Timperley

Exquisite 3 Bedroom Semi-Detached House To Let in Timperley, Altrincham

This charming 3-bedroom semi-detached house is available for rent, offering an idyllic living experience for you and your loved ones. With a monthly rental price of just £1550, nestled in a tranquil neighbourhood, this house boasts a cozy and inviting atmosphere. Step inside, and you'll find a thoughtfully furnished home that combines comfort and style. Conveniently located in Timperley, less than a 10 minute drive to Altrincham town centre, this house enjoys close proximity to an array of amenities. Great schools and a location that is safe, secure and quiet with lovely neighbours. This is an opportunity you don't want to miss!

All the bills have not been included and the price is based just on rental alone

For further details, please contact our office.



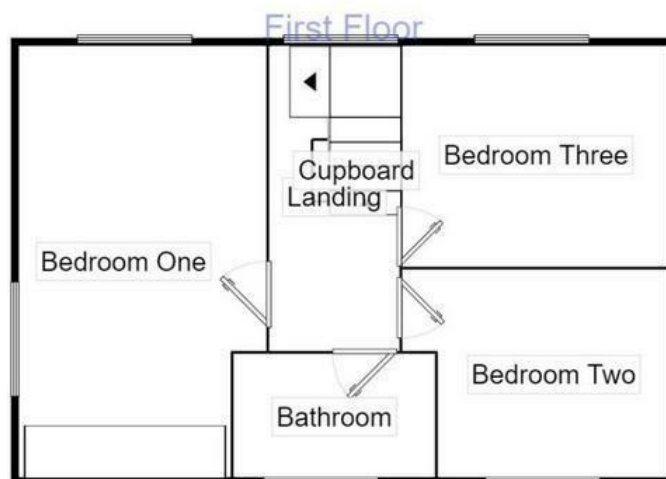

Measurements are approximate. Not to scale. For illustrative purposes only.

Council Tax Band

B

Energy Performance Graph

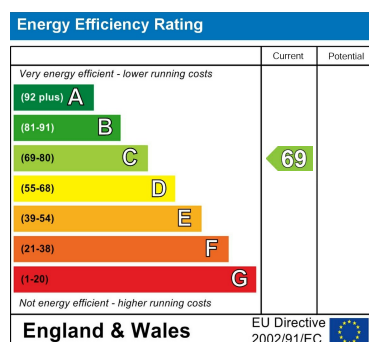

Call us on

01615 180808

info@movedirect.org

www.movedirect.org

Agents Note: Whilst every care has been taken to prepare these particulars, they are for guidance purposes only. All measurements are approximate and are for general guidance purposes only and whilst every care has been taken to ensure their accuracy, they should not be relied upon and potential buyers are advised to recheck the measurements.