

FREEHOLD



House - Semi-Detached

82 HEMPCROFT ROAD, TIMPERLEY, WA15 7JF

Guide price

£360,000

FEATURES

- Freehold Property
- Private Garage
- Cozy Living Room
- Extensive Size Plot With Approved Permission to Extend 3 metres Double Storey
- No Onward Chain
- Recently Refurbished Stylish Kitchen
- Large Driveway For Several Vehicles
- Big Garden



MOVE
DIRECT

3 Bedroom House - Semi-Detached located in Timperley

Exquisite 3 Bedroom Semi-Detached House For Sale in Timperley, Altrincham

Welcome to this charming semi-detached house located on the desirable Hempcroft Road in Timperley. This property boasts a spacious 1,044 sq ft of living space, perfect for a growing family or those looking for a bit of extra room to spread out.

Nestled in a tranquil neighbourhood, this charming 3-bedroom semi-detached house is offering an idyllic living experience for you and your loved ones. The house boasts a cozy and inviting atmosphere. Step inside, and you'll find a thoughtfully designed home that combines comfort and style. Conveniently located in Timperley, less than a 10 minute drive to Altrincham town center, this house enjoys close proximity to an array of amenities. Great schools and a location that is safe, secure and quiet with lovely neighbours. This is an opportunity you don't want to miss!

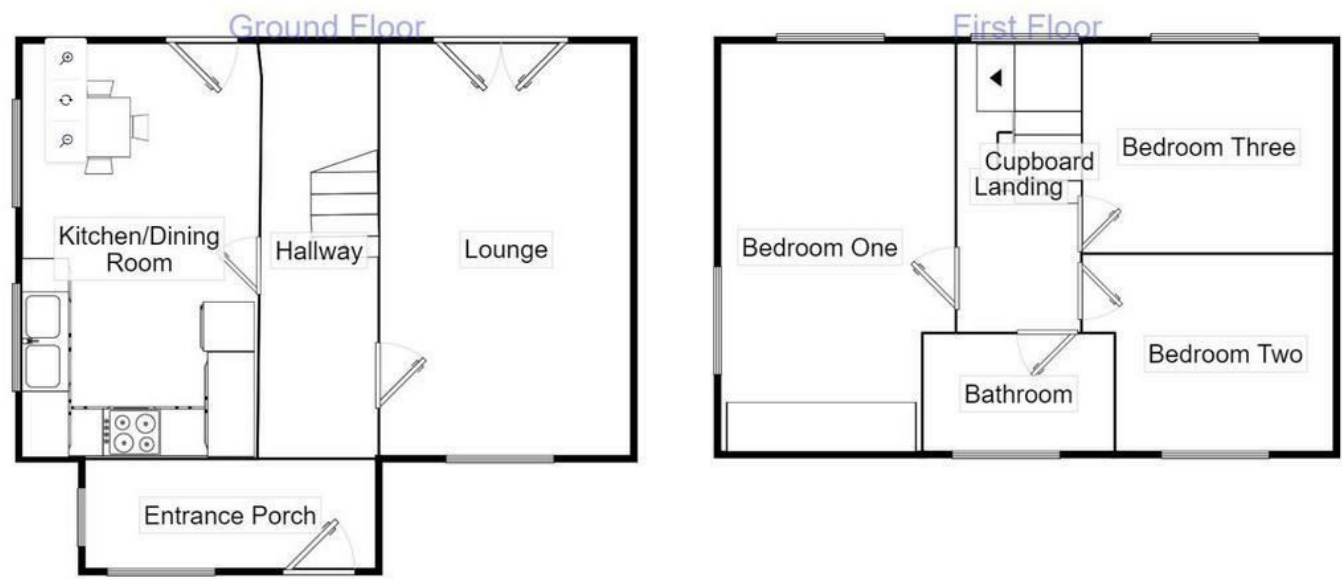

Measurements are approximate. Not to scale. For illustrative purposes only.

Call us on
01615 180808
info@movedirect.org
www.movedirect.org

Council Tax Band
B

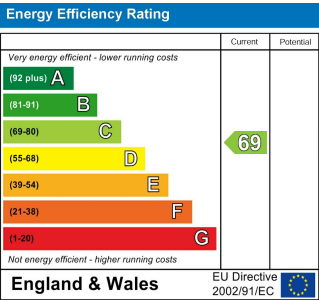

Agents Note: Whilst every care has been taken to prepare these particulars, they are for guidance purposes only. All measurements are approximate and are for general guidance purposes only and whilst every care has been taken to ensure their accuracy, they should not be relied upon and potential buyers are advised to recheck the measurements.

